

START HERE!

READ ME FIRST

Don't be a hero and muscle through this installation without reading these fitting instructions first! Improper installation of this gear may void certain aspects of your warranty.

Before you begin, take a moment and open all your Front Runner rack kit boxes and gather the assembly instructions for the various components.

A complete kit will contain:

1. A Front Runner Mounting System specific to your vehicle
2. A Front Runner Rack Tray or Load Bar Slats

This document will guide you through the assembly of the mounting system and assist you in fitting the roof rack tray or load bars to your specific vehicle.

Please refer to the next page for a list of all the components, quantities and tools required.

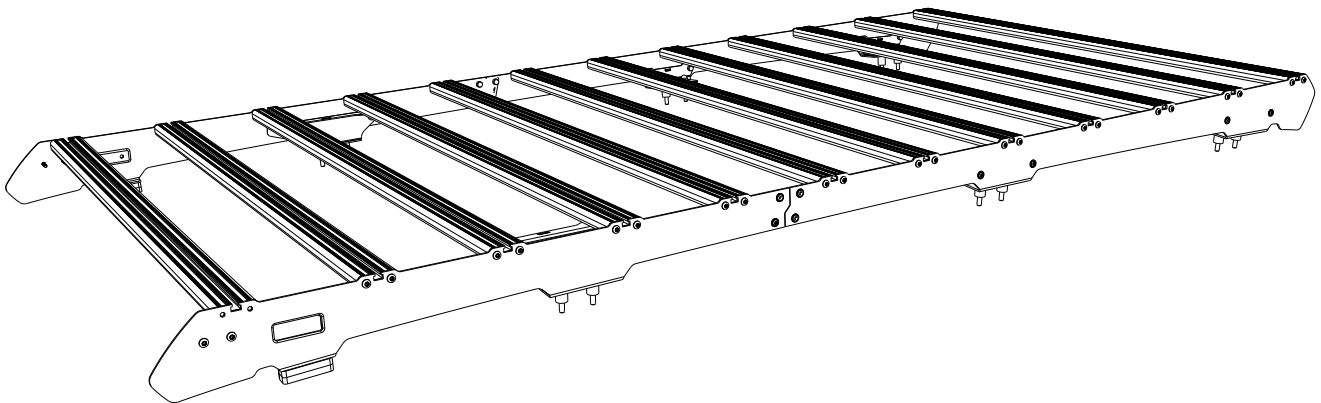

IMPORTANT WARNING!

IT IS CRITICAL THAT ALL FRONT RUNNER PRODUCTS BE PROPERLY AND SECURELY ASSEMBLED AND ATTACHED TO YOUR VEHICLE. IMPROPER ATTACHMENT COULD RESULT IN AN AUTOMOBILE ACCIDENT, AND COULD CAUSE SERIOUS BODILY INJURY OR DEATH. YOU ARE RESPONSIBLE FOR ASSEMBLING AND SECURING ALL FRONT RUNNER PRODUCTS TO YOUR VEHICLE, CHECKING THE ATTACHMENTS PRIOR TO USE, AND PERIODICALLY INSPECTING THE PRODUCTS FOR ADJUSTMENT, WEAR AND DAMAGE. THEREFORE, YOU MUST READ AND UNDERSTAND ALL OF THE INSTRUCTIONS AND PRECAUTIONS SUPPLIED WITH YOUR FRONT RUNNER PRODUCT PRIOR TO INSTALLATION OR USE. IF YOU DO NOT UNDERSTAND ALL OF THE INSTRUCTIONS AND CAUTIONS, OR IF YOU HAVE NO MECHANICAL EXPERIENCE AND ARE NOT THOROUGHLY FAMILIAR WITH THE INSTALLATION PROCEDURES, YOU SHOULD HAVE THE PRODUCT INSTALLED BY A PROFESSIONAL INSTALLER OR OTHER QUALIFIED PERSONNEL.

NOTE: Front Runner will not be responsible for any damage caused by the failure to install the product according to these instructions.

Please call us if you have any questions about the installation of this product.



1 GET ORGANIZED

IN THE BOX

- | | | |
|----|------|------------------------------|
| 1 | 2 X | Front Foot Rail / LH & RH |
| 2 | 2 X | Rear Foot Rail / LH & RH |
| 3 | 2 X | Rear Support Gusset |
| 4 | 2 X | Middle Support Gusset |
| 5 | 2 X | Front Support LH & RH |
| 6 | 2 X | Joiner Plate |
| 7 | 12 X | Tube Spacers |
| 8 | 12 X | M8 x 19 x 2 Flat Washer |
| 9 | 12 X | M8 x 50 Hex Bolt |
| 10 | 16 X | M8 Nut Cap |
| 11 | 4 X | M8 Nyloc Nut |
| 12 | 4 X | M8 x 16 x 1.6 Flat Washer |
| 13 | 18 X | M6 Nyloc Nut |
| 14 | 18 X | M6 Nut Cap |
| 15 | 4 X | Front Spacer |
| 16 | 52 X | M6 x 25 Thread Forming Screw |

IN THE BOX

- | | | |
|----|------|----------------------------------|
| 17 | 2 X | M6 x 30 Countersink |
| 18 | 2 X | Double Sided Tape |
| 19 | 16 X | M6 x 16 Flange Button Head Screw |
| 20 | 4 X | M8 x 20 Hex Bolt |
| 21 | 12 X | Slat |

TOOLS NEEDED

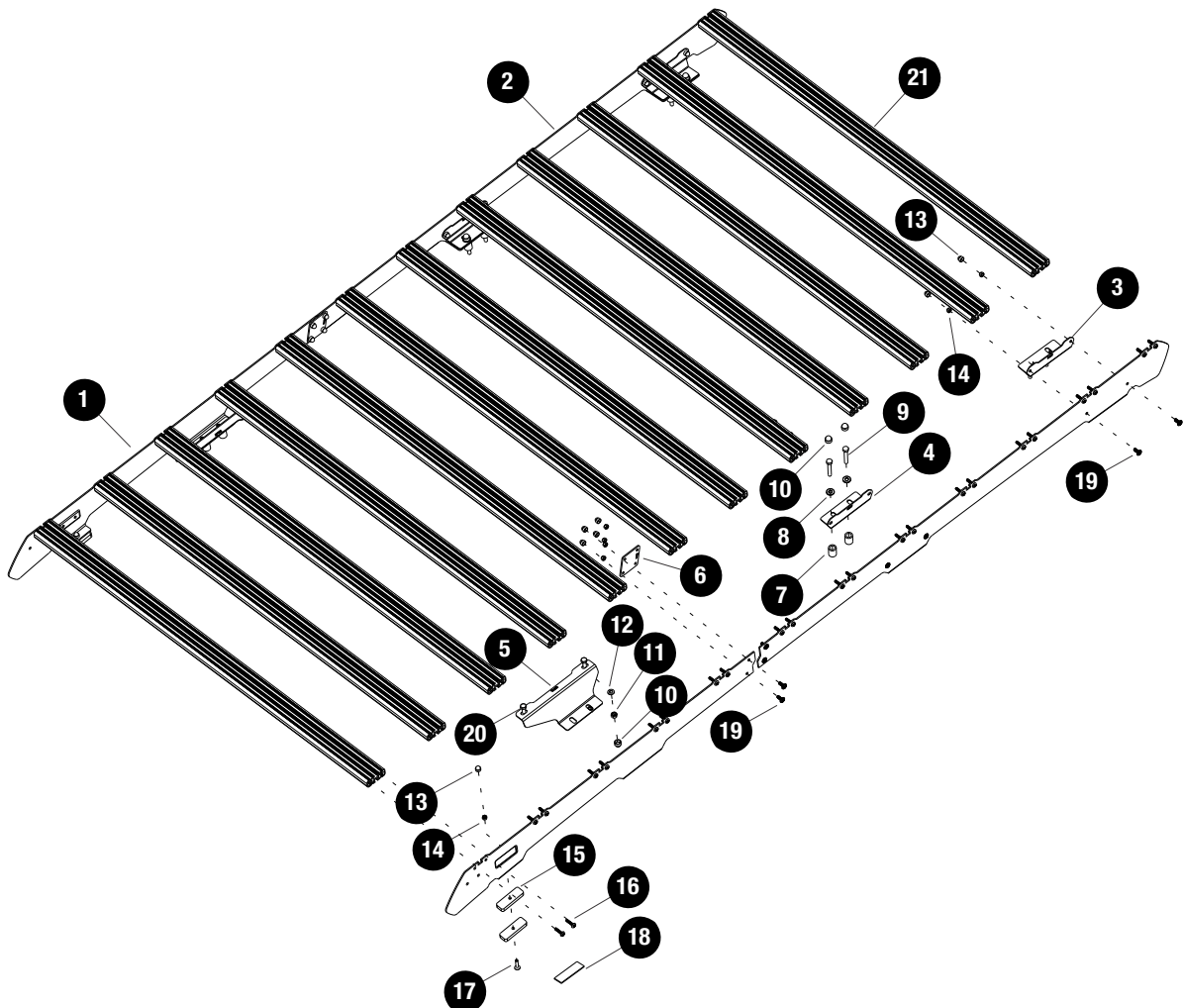
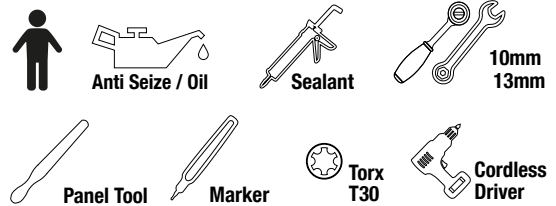

2

FIT AND SECURE

2.1

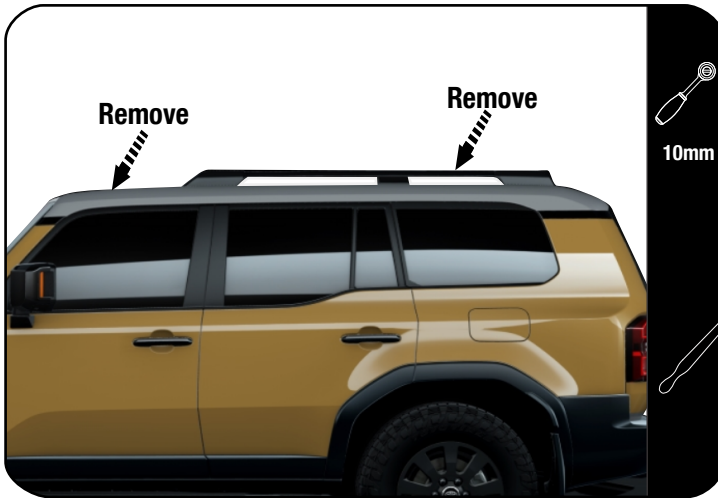

Remove the Factory Roof Rails and Saddle Brackets.

If you don't have Roof Rails fitted, remove the factory covers and Saddle brackets.

Also remove the front part of the ditch trim.

2.2

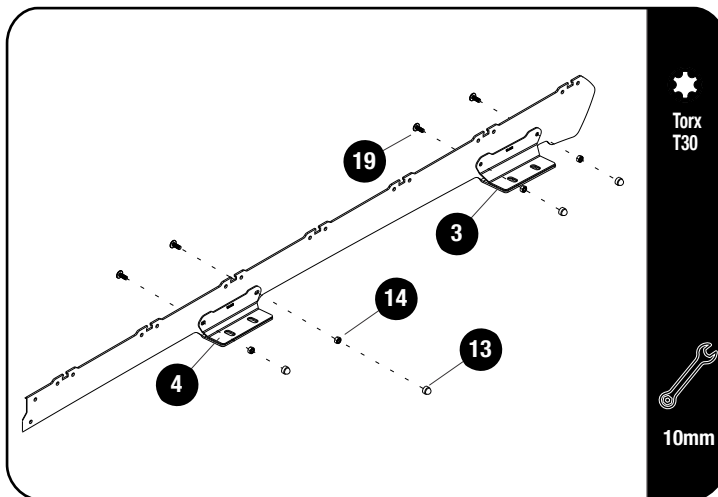

Tightening Torque:

M6 : 8-10Nm / 5.9 ft lb - 7.38 ft lb



Assemble the Middle and Rear Support Gussets (Items 3 & 4) to the Rear Foot Rail (Item 2) using M6 x 16 Flange Button Head Screws and M6 Nyloc Nuts (Items 14 & 19)

Do this on both left and right foot rails.

Fully tighten before placing M6 Nut Caps (Item 13) over all Nyloc Nuts.

2.3

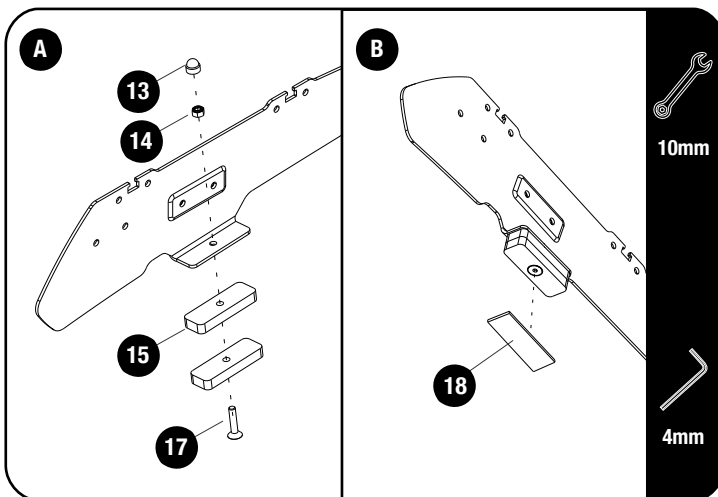

Assemble two of the 10mm Spacers (Item 15) to the Front Foot Rail (Item 1) using a M6 x 30 Countersink bolt and M6 Nyloc Nut (Items 14 & 17) as shown.

Place a M6 Nut Cap (Item 13) on the Nyloc Nut.

Do this on both left and right side Foot Rails.



Apply Double Sided Tape (Item 18) to the bottom of the Spacer.



The backing of the tape will be removed in 2.9.

2 FIT AND SECURE

2.4

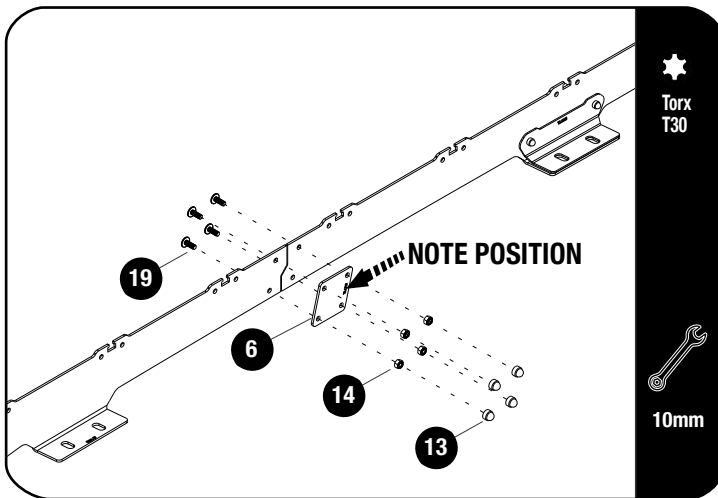

Assemble the Front and Rear Foot Rail assemblies from 2.2 and 2.3 using M6 x 16 Flange Button Head Screws and M6 Nyloc Nuts (Items 14 & 19).



Note position of ID marking.

Do this on both left and right foot rails. Fully tighten before placing M6 Nut Caps (Item 13) over all Nyloc Nuts.

2.5

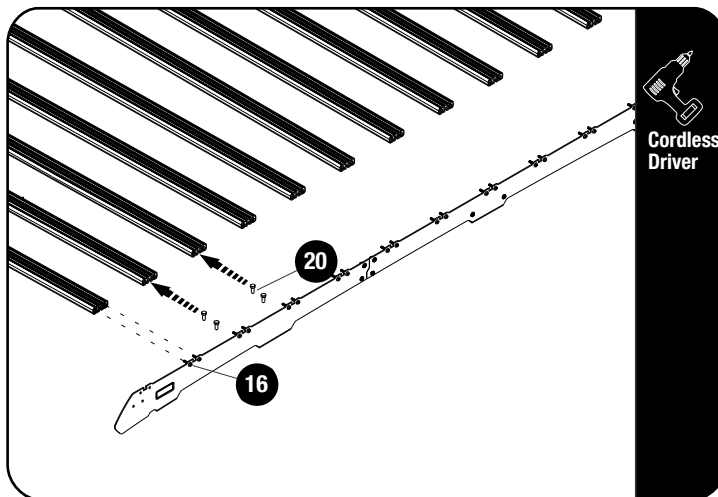

Fit 11 Slats (Item 21) to the Foot Rail assemblies from 2.4 using M6 x 25 Thread Forming Screws (Item 16).



Note do not fit front slat.



Slide 4 M8 x 20 Hex Bolts (Item 20) into the 3rd and fourth Slat, 2 per slat before you secure the Foot rails to the Slats.



Apply a little Anti Seize / oil on screw threads before inserting. Note these are thread forming screws.



Tightening Torque 8-10Nm / 5.9 ft lb - 7.38 ft lb. Take care when using a cordless driver.

2.6

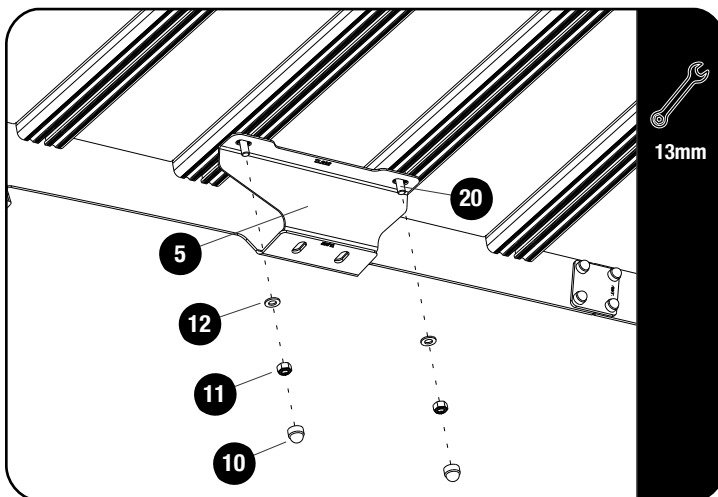

Secure the LH and RH Front Supports (Items 5) to the underside of the 3rd and 4th slat using the bolts inserted in 2.5, M8 Nyloc Nuts and M8 x 16 x 1.6 Flat Washers (Items 11 & 12) as shown.

Fully tighten all fasteners before placing M8 Nut Caps (Item 10) onto the Nyloc Nuts.

2.7

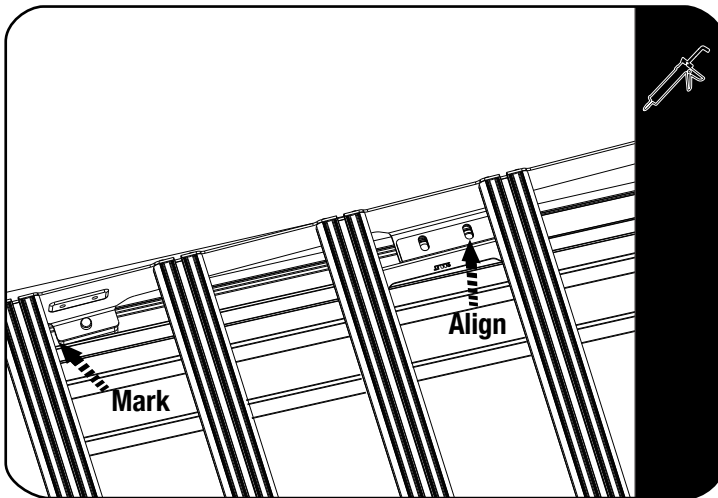

Place the Foot Rail in the ditch and align the slots of the mount with the OEM holes in the vehicle.

Mark the position of the front foot in the ditch.

Remove the rail from the vehicle.

Do this on the left and right side of the vehicle.

Clean the area where the double sided tape will be attached.

2.8

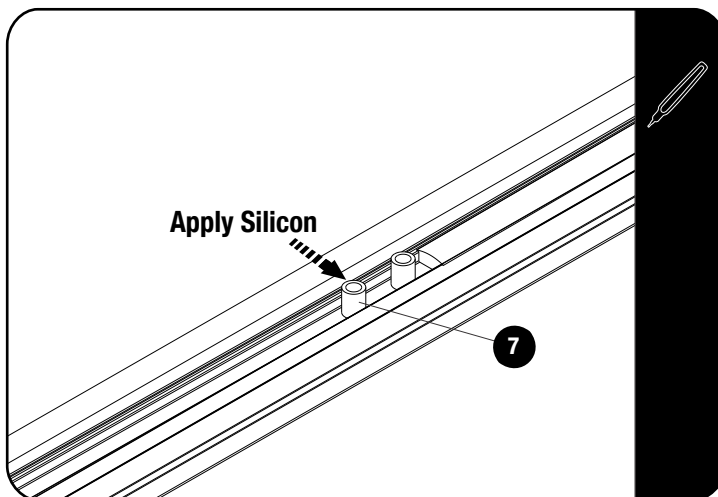

Place the Tube Spacers (Item 7) over each of the mounting points where the OEM rails were in 2.1.

Apply a bead of silicon in and around each mounting hole and Spacers.

Do this on all six mounting points.

2.9

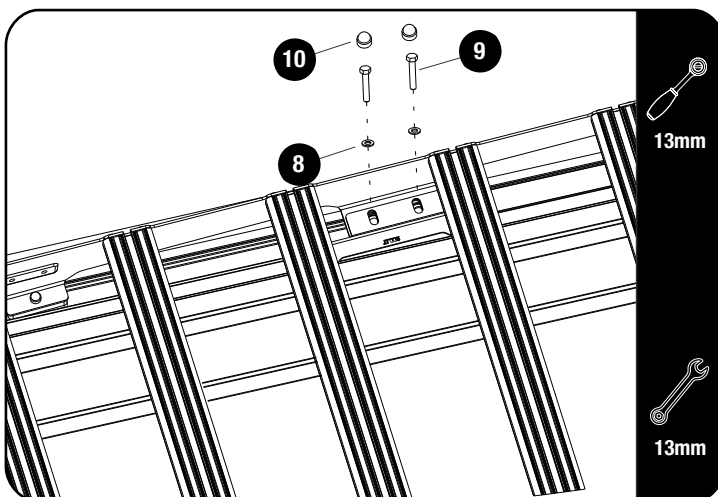

Remove the backing from the tape before placing the Foot Rail back into the ditch.

Ensure that the Front Foot is aligned with the mark made in 2.8 before securing the rail.

Loosely fit M8 x 50 Hex Bolts with M8 x 19 x 2 Flat Washers (Items 8 & 9) into the rest of the mounting points.

Fully tighten all fasteners.



Tightening Torque:

M8 : 15-20Nm / 11.06 ft lb - 14.75 ft lb

4.1

STANDARD WIND FAIRING ASSEMBLY

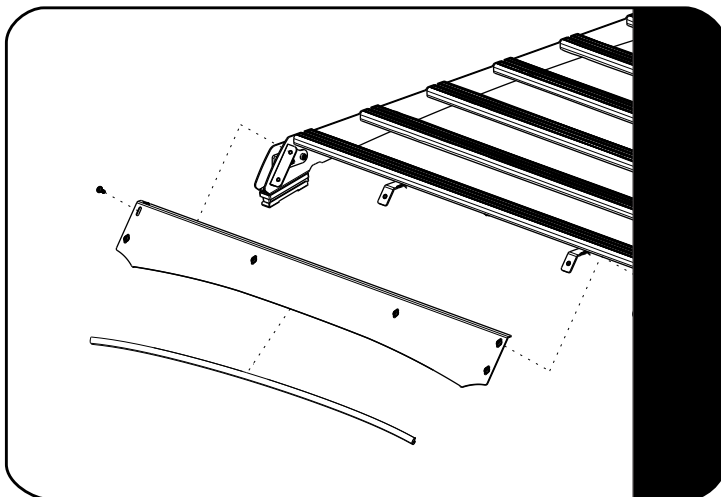

Refer to fitment guide RRAC340

4.2

LIGHT BAR WIND FAIRING ASSEMBLY

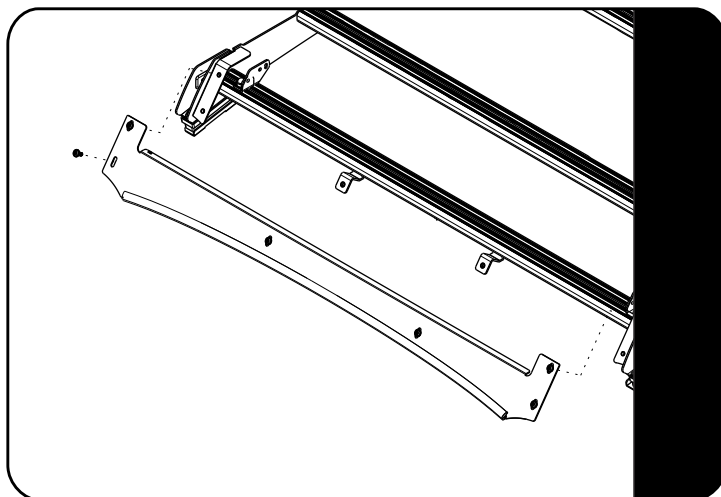

Refer to fitment guide RRAC341

5

COMPLETION

5.1

Congratulations! You did it. Take a step back and admire your work!



6

INSTALL OTHER VEHICLE AND RACK ACCESSORIES

Now's the time to visit your favorite Front Runner dealer in person or online.

IMPORTANT!

FRONT RUNNER RACK KITS OFTEN HAVE A HIGHER LOAD RATING THAN THE VEHICLES THEY ARE MOUNTED TO. PLEASE REFER TO YOUR SPECIFIC VEHICLE MANUFACTURER FOR A RECOMMENDED ROOF RATING. FRONT RUNNER CANNOT BE RESPONSIBLE FOR IMPROPER LOADING BEYOND THE VEHICLE MANUFACTURER'S STATED LOAD CAPACITY.

Be sure to tag us. We love to see our gear in action! #FrontRunnerOutfitters #BornToRoam

Share your adventures on: 